



# Ewa by Gentry Community Association

91-1795 Keaunui Drive, Ewa Beach, HI 96706

Tel: (808) 685-0111 www.ewabygentry.net

## 17. Exterior Security Devices

Design Committee approval is required for all exterior security devices. These include cameras, doorbell cameras, security lights and audible devices.

- A. Exterior security devices shall be mounted under the roof eaves. If the device is mounted on the gable end of the house (for gable roofs), it shall be mounted within twelve (12) inches of the roof peak.
- B. Devices shall not be directed into neighboring properties.
- C. Wiring should be installed so it is not visible from the street or neighboring property. Wiring may be installed in conduit if the conduit is painted to match the color of the material to which it is attached.
- D. Any security light, including motion-sensitive lighting, must be of residential grade (not industrial or commercial) and must match the color of the house or trim.
- E. Any fixture that generates a verified complaint from a neighboring property shall be redirected, relocated, or removed upon written notification by EbGCA.

### Application Packet Requirements:

- A complete Design Committee application form signed by the Homeowner
- Closing Plot Plan showing the proposed or existing location for each security device. If this is a multiple installation, each device location must be numbered
- Manufacturer's brochure or photo including:
  - Spec sheet for each different device
  - Photo of each different device
- Photos showing:
  - The proposed or existing locations of each camera, light or audible device
    - Each camera or audible device should be numbered to correspond to the numbers on the plot plan
    - Photo should be taken so it is obvious where the camera will be installed and to correspond with what is shown on plot plan
  - Any proposed or existing external conduit/wiring routing and location
  - What will be visible from each camera installed
    - Each photo must be numbered to correspond with the number shown on the plot plan
    - Photo should be taken from where the proposed camera will be installed showing a mock view

EXAMPLE:

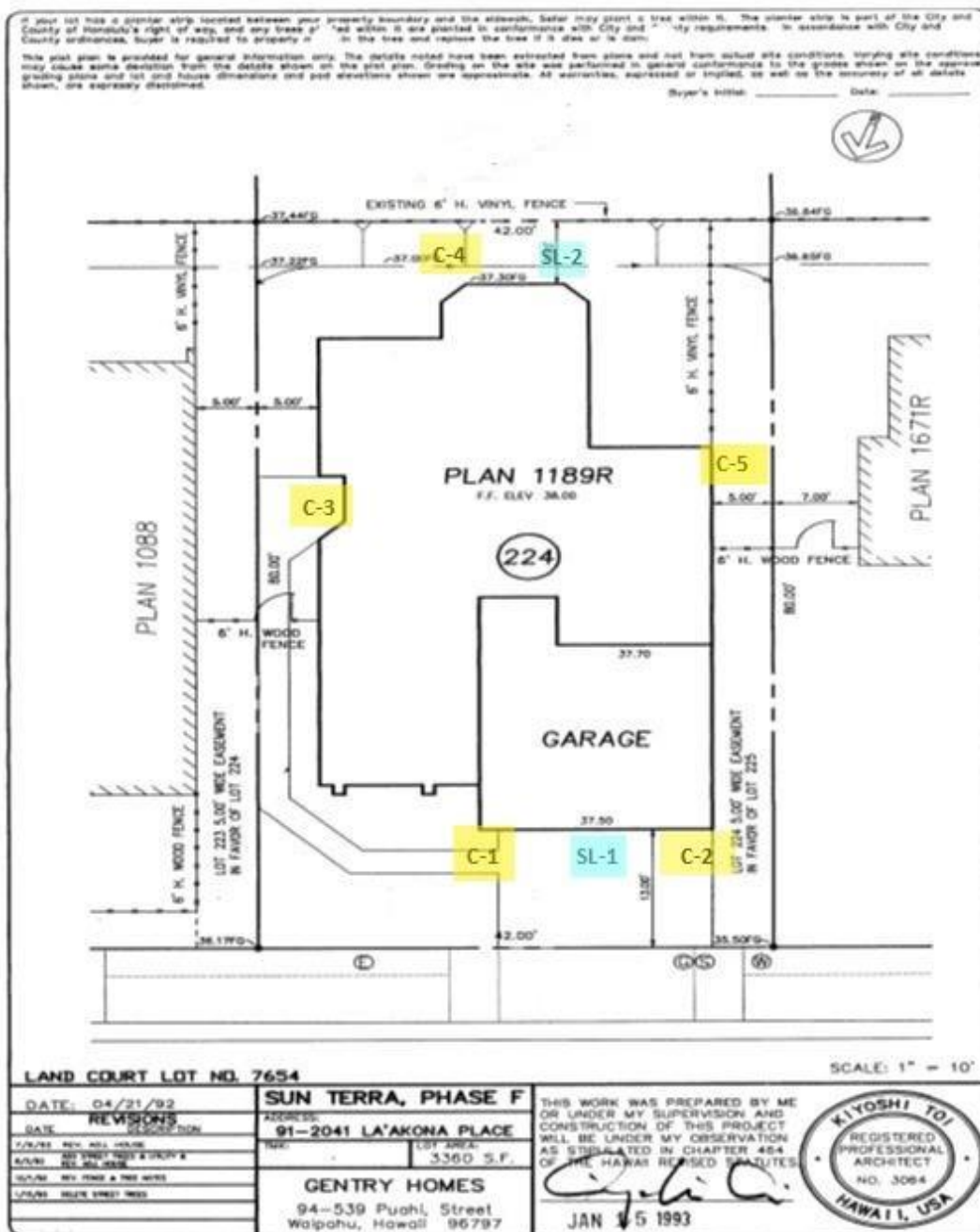

Label each photo with the corresponding label on the plot plan.

Camera Location:

- Photo 1 – Camera 1 = C-1
- Photo 2 – Camera 2 = C-2
- Photo 3 – Camera 3 = C-3
- Photo 4 – Camera 4 = C-4
- Photo 5 – Camera 5 = C-5

Camera View:

- Photo 6 – Camera 1 = C-1
- Photo 7 – Camera 2 = C-2
- Photo 8 – Camera 3 = C-3
- Photo 9 – Camera 4 = C-4
- Photo 10 – Camera 5 = C-5

Security Light Location:

- Photo 11 – Security Light 1 = SL-1
- Photo 12 – Security Light 2 = SL-2